

CUTTER WHEELS

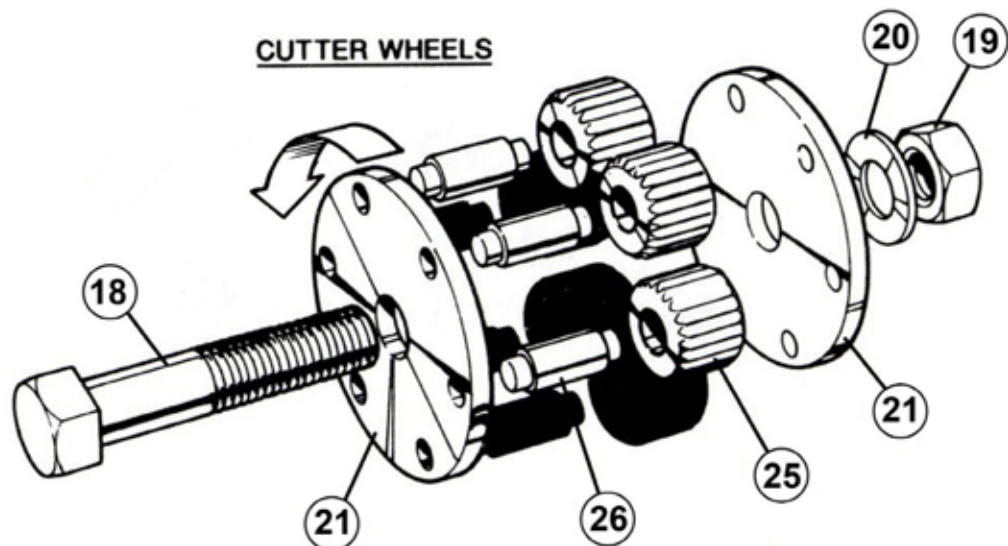

CHIPPING LEAVES

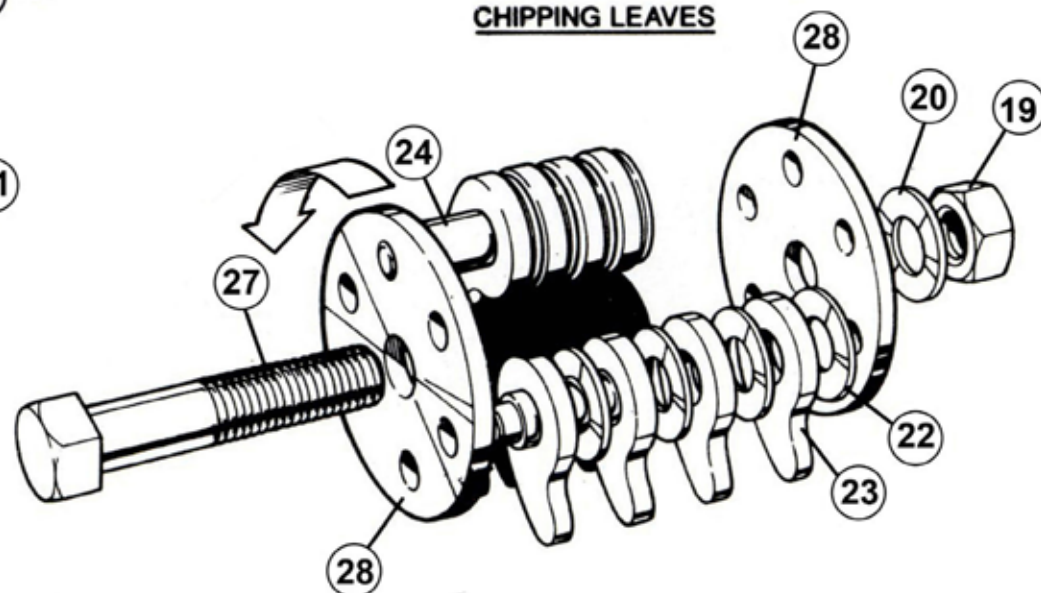

WIRE BRUSH

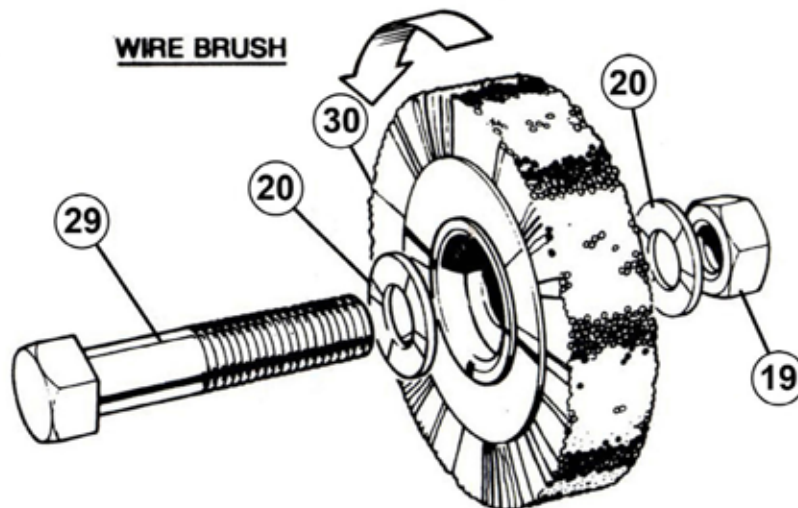

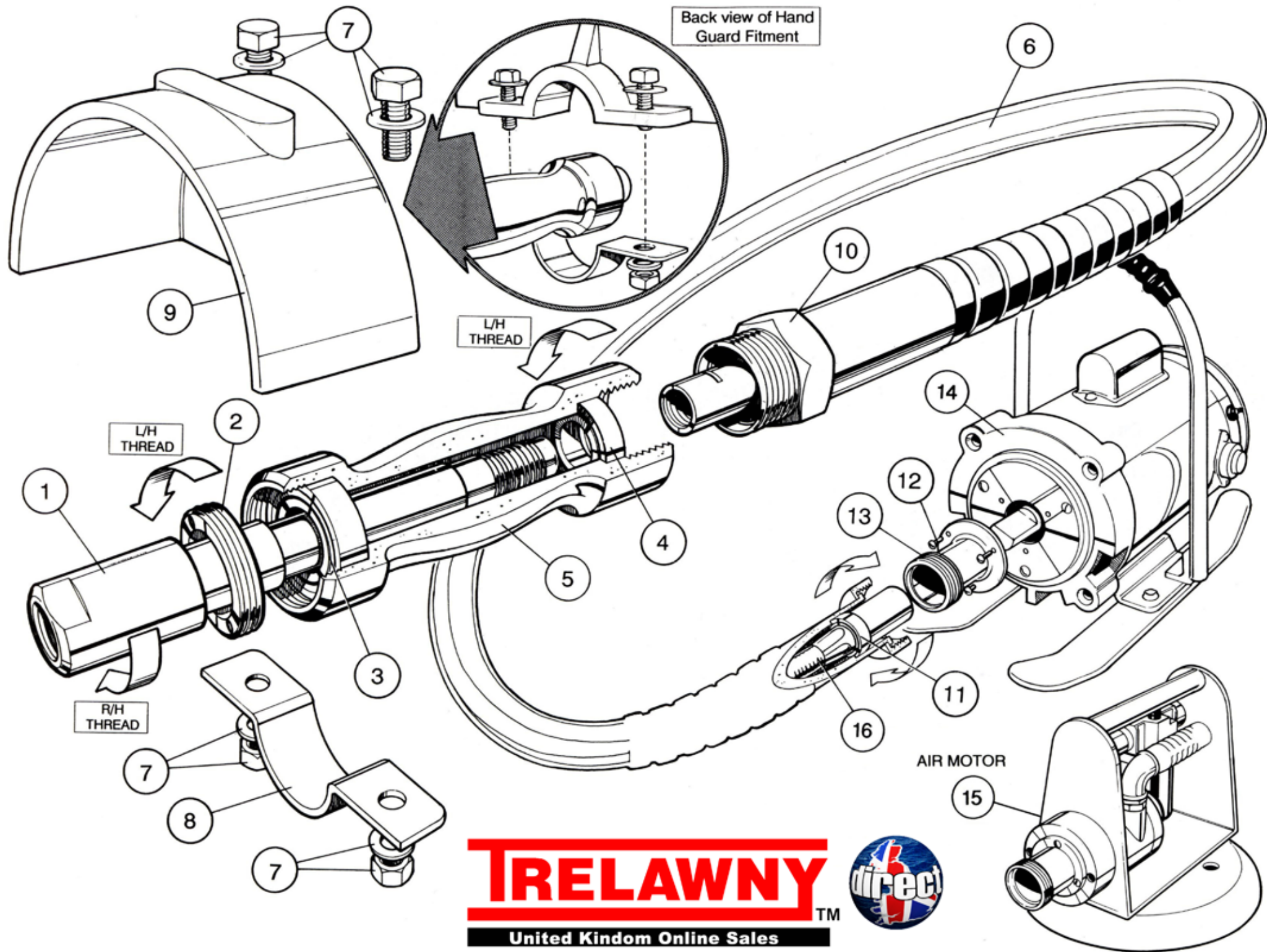

Item	Part Number	Description	Item	Part Number	Description
1	340.542	Dumbbell Handle Spindle	23b	340.348	Thin Chipping Leaf (not shown)
2	340.536	Front Cap	24	340.553/12	Leaf Pin for Scaling Head (Pack of 12)
3	340.251	Ball Race (Large)	24a	340.546	Leaf Pin for Single Leaf Scaling Head
4	340.252	Ball Race (Small)	24b	340.556	Leaf Pin for Light Duty Scaling Head
5	340.541	Dumbbell Body			
5a	340.540	Dumbbell Handle Assembly	25	340.332	Cutter Wheel
6	340.290	Outer Drive Casing Assembly	26	340.583/12	Cutter Wheel Pin (Pack of 12)
6a	340.285	Flexible Drive Assembly	27	340.552	Centre Bolt for Chipping Leaves
7		Nut / Bolt & Washer Set (Part of item 9)	27a	340.545	Centre Bolt for Single Leaf Cutting Head
8		Hand guard Clamp (Part of item 9)	28	340.551/2	Side Plate for all Chipping Leaves (Pack of 2)
9	340.633	Hand guard Assembly	29	340.558	Centre Bolt for 6" Power Brush
10		Threaded Hexagon Adapter (Part of item 6)	29a	340.559	Centre Bolt for 6" Twisted Knot Brush
11	340.252	Ball Race	29b	340.557	Centre Bolt for Crimped Wire Cup Brush
12	340.TN/11	Domed Screw			
13	340.664A	Threaded Nose Piece	30	340.160	6" Crimped Wire Power Brush
14	340.TN/110	Electric Motor (inc Skid)	30a	340.166	Crimped Wire Cup Brush
15	340.490	Air Motor (inc base)	30b	340.167	Twisted Knot Cup Brush
16	340.288	Inner Shaft	30c	340.548	Thin Leaf Scaling Head
18	340.581/A	Centre bolt for 6 Cutter Scaling Head	30d	340.550	Heavy Duty Scaling Head
19	340.160A	Hexagon Nut	30e	340.581	6 x Cutter Scaling Head
20	340.584	Washer	30f	340.163	6" Twisted Knot Power Brush
21	340.575/2	Side Plate for 6 Cutter Scaling Head (Pack of 2)			
22	340.584/50	Washer for Leaf Scaling Head (Pack of 50)			
23	340.347/24	Chipping Leaf (Pack of 24)			